

WORK COUNTER UNITS...WOOD

Madix's wood pharmacy units combine a modern appearance with practical efficiency. Featuring wood construction with easy to clean exteriors, Madix under counter units afford the flexibility to custom design any pharmacy to meet all of one's particular needs. Precision construction with attention to detail assures accurate fixture alignment. Madix provides a system that is flexible, durable and attractive.

FOUR DRAWER CARD FILE^A



Four drawers, each drawer has three card followers, dividers and card levelers, *field installed*, to fit all size index cards.

PWD-424-CF	<i>Wt.</i>
\$665.55	155.0

* File less card followers...delete - CF, subtract \$251.05

NOTE!
All work wood counter units come with standard "HINGE RIGHT" doors. "HINGE LEFT" doors are available by adding the suffix **-DHL** to the part number.
EXAMPLE: PWA-224D-DHL

OPEN UNIT^A

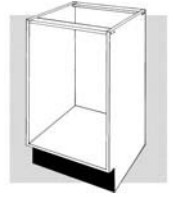

Madix Standard Basic Open unit with six shelf and door options presented on this page.

PWA-24	<i>Wt.</i>
\$187.40	72.0

BOTTLE UNIT^A



Two 10 degree slant bottle drawers with four adjustable dividers and small bottom drawer.

PWB-24	<i>Wt.</i>
\$334.40	106.0

OPEN UNIT...two shelves^A

Basic open unit with two adjustable interior shelves.



PWA-224	<i>Wt.</i>
\$244.20	98.0

SINK UNIT^A



Full height door conceals access to plumbing. Includes stainless steel sink, *installed in countertop at job site.*

PWS-24	<i>Wt.</i>
\$531.30	96.5

DOOR UNIT...two shelves^A

Full height door with two adjustable interior shelves.



PWA-224D	<i>Wt.</i>
\$342.65	115.0

NARCOTICS UNIT^A



Locking top drawer with two drop front drawers behind locking door.

PWN-24	<i>Wt.</i>
\$496.20	120.0

LOCKING DOOR UNIT...two shelves^A

Full height locking door with two adjustable interior shelves.



PWA-224DL	<i>Wt.</i>
\$359.25	115.0

FIVE DRAWER UNIT^A



Five drawers, with six inch vertical interior clearance, *no dividers...see drawer divider kit, DU-DK.*

PWD-524	<i>Wt.</i>
\$448.25	123.0

OPEN SECTION HEADER KIT^A

Includes 36" wide back, header and all hardware to seal off rear of open areas when 30" counter-top is used or when open area is more than 24" wide.



PW-HK	<i>Wt.</i>
\$52.70	5.0

WASTE UNIT^A



Short door leaves opening at top for waste container access. *Waste container not included.*

PWW-24	<i>Wt.</i>
\$285.00	98.0

OPEN UNIT...drawer, one shelf^A

Basic open unit with single drawer plus one adjustable shelf.



PWADR-124	<i>Wt.</i>
\$300.25	103.0

PWA/CRT UNIT^A



Angled footrest is covered with durable hard ribbed rubber. *Adjustable shelf not shown.*

PWCRT242438	<i>Wt.</i>
\$335.80	103.5

DOOR UNIT...drawer, two shelves^A

Short height door with two adjustable interior shelves.



PWADR-224D	<i>Wt.</i>
\$398.70	120.0

SINGLE DRAWER^A



Use as a single drawer in a run of work units with open space underneath.

PDU6-24	<i>Wt.</i>
\$77.05	24.3

DRAWER DIVIDER KIT^A

Five dividers with plastic banding strip...*self adhesive, easily field installed.*

DU-DK	<i>Wt.</i>
\$30.70	5.0

LOCKING DOOR UNIT...drawer, two shelves^A

Full height locking door with two adjustable interior shelves.



PWADR-224DL	<i>Wt.</i>
\$415.25	120.0

• All units are 24"W x 24"D x 38"H

• Finish on all units is Melamine Snow White, MSW.

PRESCRIPTION SERVICE COUNTER^B

RECOMMENDED UNIT HEIGHTS

See Wall sections in the Gondola/Wall Section of the catalog. See Gondola/Wall Section for Shelves and End Panels. For Countertop information see Countertop page in the Gondola/Wall Section of the catalog. Add 2½" to length when ordering prescription service counter-top! EXAMPLE: CTO20 - 194½".

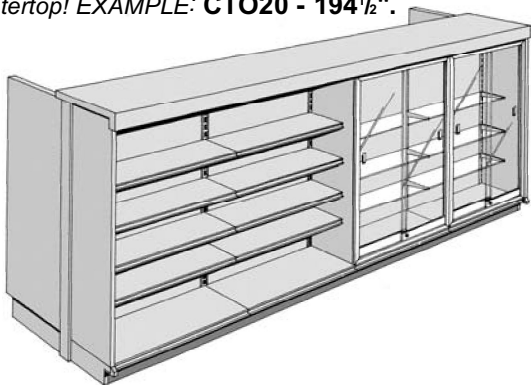

54" HIGH WALL WITH 48" HIGH DOOR KIT or 60" HIGH WALL WITH 54" HIGH DOOR KIT

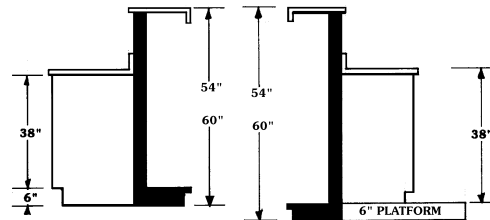

FIXTURE HEIGHT SLIDING DOOR KITS
—SEE PAGE CONTAINING PART NUMBER SDKF

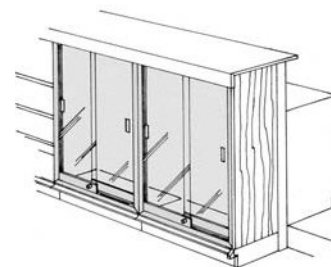

NOTE: FOR LIGHT INSIDE DOOR KIT UNDER CTO COUNTERTOP, MINIMUM BASE SHELF DEPTH IS 14" ...SEE LIGHT KIT PAGE

PRESCRIPTION WORK COUNTERTOP^B

Solid wood construction, white leather laminate surface and edges. Choice of 24" or 30" widths with 4" high back splash. Available in lengths up to 96"...longer tops are joined at job site by combination dowel and "Tite-joint" combination, insuring a smooth surface. If PWS-24 sink unit is used, countertop must be cut to fit at job site.

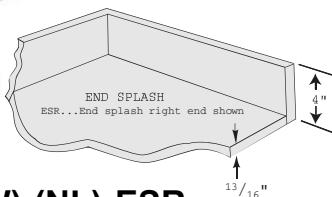
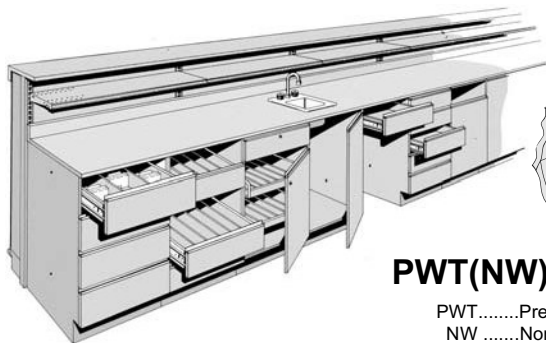

PWT(NW)-(NL)-ESR

PWT.....Prescription Work Countertop
NWNominal Width 24" or 30" (60.96 cm or 76.20 cm)
NLNominal Length (See Ordering Supplement)
ESREnd Splash Option ESR = Right End ESL = Left End ESB = Both Ends

		Weight
PWT24-□□□	\$42.50 per foot *	7 lbs. per linear foot
PWT30-□□□	\$49.45 per foot *	8.3 lbs. per linear foot

*Round to nearest foot.
• Add \$19.55 for each end splash.

FINISH CODE LL

LL ... LL = WHITE LEATHER (Standard)
.....See the Finishes Brochure for Options

ORDERING SUPPLEMENT

...FOR ORDERING PRESCRIPTION WORK COUNTERTOPS



ORDER PWT @ NOMINAL LENGTH + 0" FOR EACH END THIS CONDITION WILL EXIST

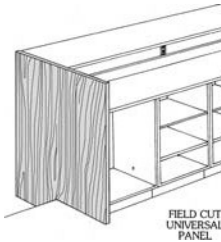

ORDER PWT @ NOMINAL LENGTH + 1¼" FOR EACH END THIS CONDITION WILL EXIST
ORDER UNIVERSAL PANEL @ NOMINAL UPRIGHT HEIGHT plus 2" x PWT WIDTH plus BASE SHELF DEPTH plus 2" .



ORDER PWT @ NOMINAL LENGTH + 0" FOR EACH END THIS CONDITION WILL EXIST
ORDER END PANEL NOMINAL UPRIGHT HEIGHT x 24" OR 30".

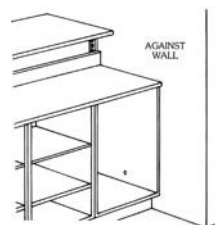

ORDER PWT @ NOMINAL LENGTH + 1¼" FOR EACH END THIS CONDITION WILL EXIST