

MIDWEST

RETAIL SERVICES, Inc

RTA H-UNIT ASSEMBLY INSTRUCTIONS

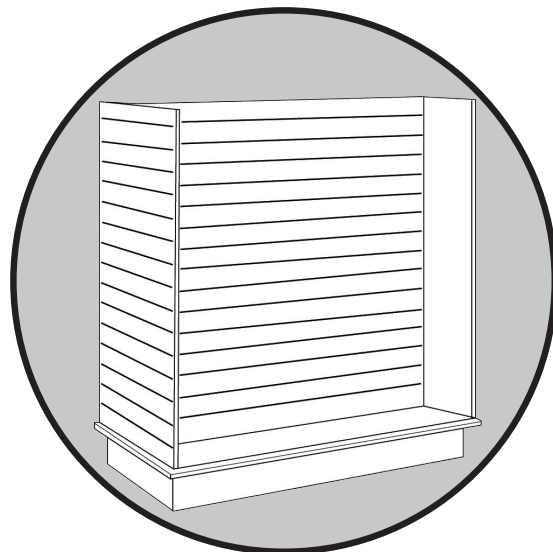

TOOLS NEEDED



#2 Phillips Screwdriver



Rubber Mallet
(optional)

KIT COMPONENTS

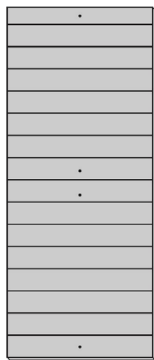

Wing Panel x 2

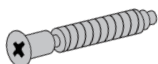

Confirmat Screw x 8

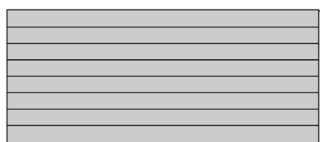

Center Panel x 2



Long Kick Base Board x 2



Camlock Pin x 21

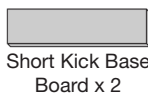

Short Kick Base Board x 2



Unfinished Kick Base Board x 1



Pan Head Screw x 24

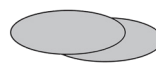

Screw Cap x 8



Kick Base Top x 1

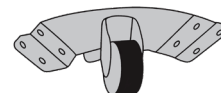

Caster x 6

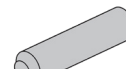

Dowel Pin x 4



Camlock x 21

KICK BASE ASSEMBLY

Figure 1

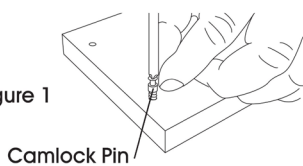

Figure 2

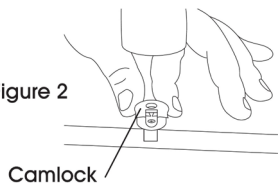

Figure 3

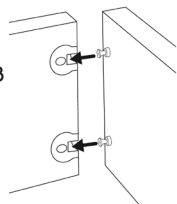
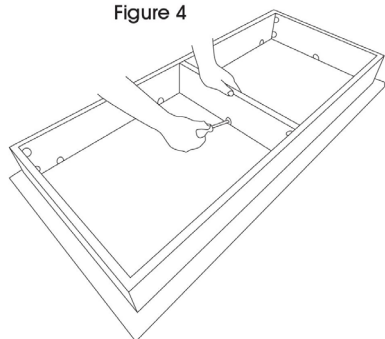

Figure 4



- 1 Set kick base top on a protective surface. Make sure the underside of the kick base top is facing up.
 - 2 Using a screwdriver, install camlock pins into the pre-drilled holes in the kick base boards and the underside of the base top. (See Figure 1)
 - 3 Install camlocks into the kick base boards and tap into position with the rubber mallet. (See Figure 2)
- NOTE:** Ensure that the opening of the camlock is facing outward and that the camlock is fully seated into position.
- 4 Connect the kick base boards so that each corner has camlock pins set into the camlocks of the adjacent board. Position boards of the same length parallel to each other. Place the shortest, unfinished board in the center. (See Figures 3 and 4)

KICK BASE ASSEMBLY (CONTINUED)

Figure 5

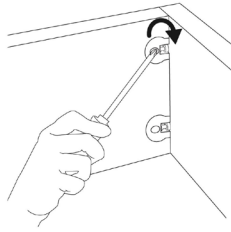

- 5 Insert the screwdriver into a camlock and turn clockwise to lock. Repeat for all camlocks. (See Figure 5)

PRO TIP: Tilt the screwdriver at an upward angle while twisting to better lock the camlocks.

CASTER INSTALLATION (OPTIONAL)

- 1 Position the casters in the kick base assembly. Place (4) casters into the outer corners and (2) casters into the center corners, with one caster on either side of the center kick base board. (See Figure 6)
- 2 To attach the casters, use (4) pan head screws per caster. Drive pan head screws through the holes in the casters and into the pre-drilled holes inside the kick base boards. (See Figure 7)

Figure 6

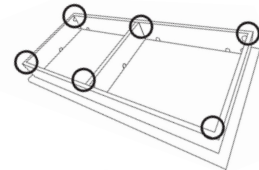
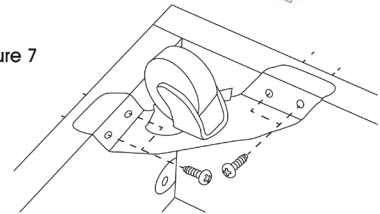

Figure 7



CENTER AND WING PANEL INSTALLATION

Figure 8

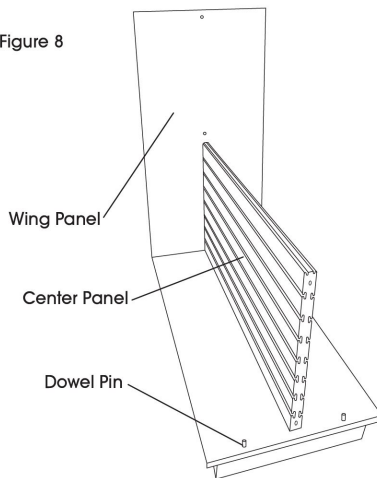
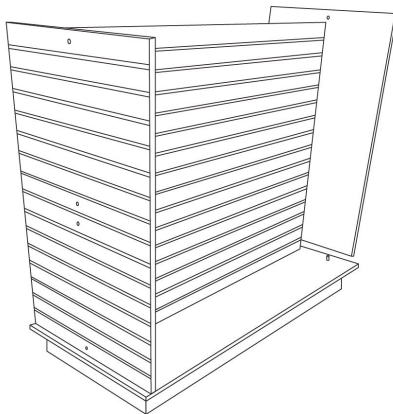

Figure 9



- 1 Flip the kick base right side up.
- 2 Set the (4) dowel pins into the pre-drilled holes on the base top.
NOTE: Two people are recommended for steps 3 through 6.
- 3 Set one wing panel onto (2) of the dowel pins. (See Figure 8)
- 4 Set one center panel on the base top and attach to the wing panel by driving confirmat screws into the pre-drilled holes. Tighten the screws with the Phillips screwdriver. (See Figure 8)
- 5 Set the second tier of the center panel on top of the first panel and secure to the wing panel as in step 4.
- 6 Set the second wing panel onto dowel pins and secure to the center panels by driving confirmat screws through the pre-drilled holes. Tighten the screws with the Phillips screwdriver. (See Figure 9)
- 7 To conceal the screw heads, peel the decorative screw cover caps to expose the sticky back, carefully center over the screw heads, and press in place.

PRO TIP: Use a black magic marker to touch up any dings or nicks to the kick base boards. Clean with a soft cloth and water.